



WERNER-VON-LINDE-HALLE

MUNICH, GERMANY, 2004-2007

Client

Olympiapark München GmbH

Architect

Behnisch & Partner

Planning and construction

1967-1972

Renovation and modernization

2004-2007, Behnisch, Behnisch
& Partner

Address

Spiridon-Louis-Ring 1
80809 Munich
Germany

The Werner-von-Linde Sports Hall was constructed as part of the Olympic Park in Munich in 1972. It was designed as a "pavilion in the park" to comply with the principles of the 1972 Olympic Games in Munich, which were, in turn, conceived as "Games in a green environment and with short routes; Games informed by the muses and sport".

The extension and refurbishment measures had become necessary because the gym as it existed at that time no longer met the technical and functional requirements of a modern training space and an Olympic support center. In the course of the planning, investigations were made to determine whether the existing gym could continue to be used and how many elements were still viable, or whether a completely new structure would make more sense. These

studies showed that above all the structure, the roof, the existing changing rooms and parts of the floor slab could be modernized functionally and technically without any great outlay. For that reason, the planning foresaw the retention of the existing fabric as far as possible. This was subjected to a restrained refurbishment and complemented by the necessary additions.

The gym is now organized on two levels. To the east, on the parking level, is the entrance for athletes and a gallery with cabins for sporting contests. On the western side is a gallery with seating for roughly 470 spectators, plus a foyer with cloakroom facilities, and a bistro. The level of the actual gym space is three metres lower. Situated here are the oval with the 200-metre running track with areas in the middle for other athletic disciplines such as the high, long

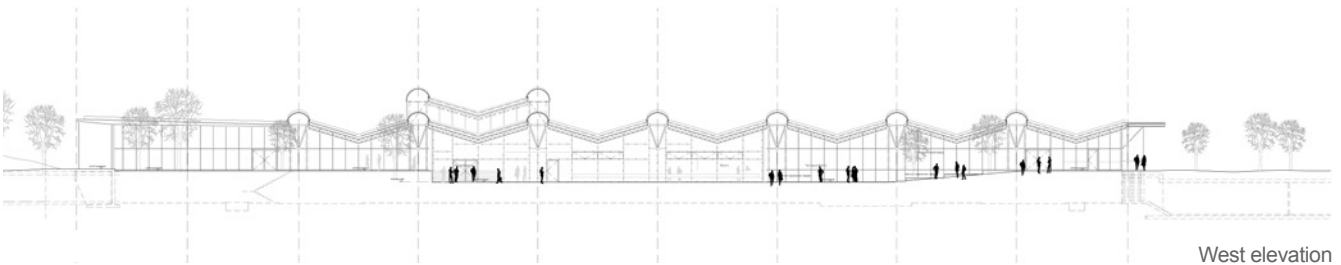

West elevation

and triple jump, pole vaulting and a 60-metre running track. Outside the oval to the north are further sports facilities.

The volume of the sports hall was increased by moving the position of the facade beneath the roof. An internal anti-glare installation provides protection against direct sunlight. Despite the many regulations that had to be observed, particular care was taken to ensure that the new facade maintains the appearance of the historic former one.

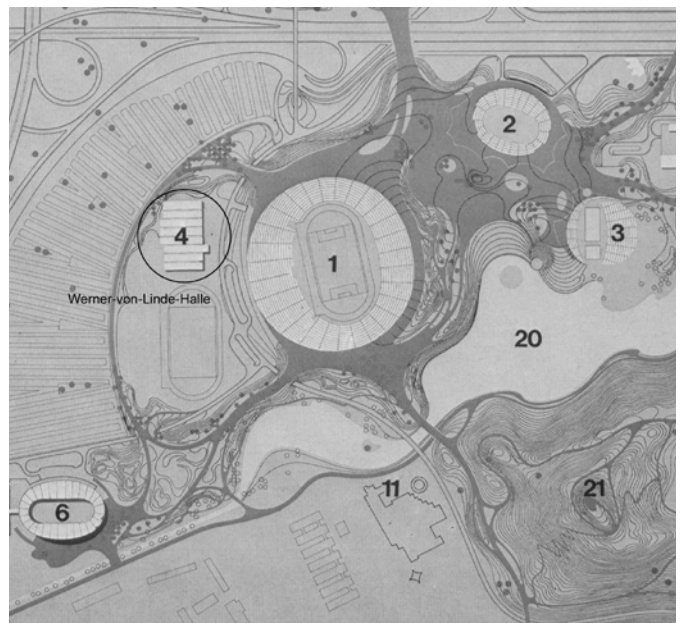

Site plan

