



CHILDREN'S DAYCARE CENTER ON SCHWETZINGER TERRASSE

HEIDELBERG, GERMANY, 2010-2012

Client

EGH Entwicklungsgesellschaft
Heidelberg GmbH & Co KG

Architect

Behnisch Architekten, Stuttgart

Competition

2009

Planning and construction

2010-2012

Gross

1.130 m² / 12,163 sq.ft.

Volume

3.835 m³ / 135,433 cu.ft.

Address

Langer Anger 27
69115 Heidelberg
Germany

The Children's Daycare Center situated in the public plaza of Schwetzinger Terrasse is one of the first buildings to be realized in Heidelberg's new city district known as „Bahnstadt“. Schwetzinger Terrasse is located at the intersection of the city with the landscape, and is intended to function as an attractive urban space that can be used in a variety of ways.

The daycare center's unique shape gives it the sense of a solitary building that evokes the semblance of an island. Upon entering the center, one reaches a generous lobby that is bathed in daylight, with part of the space rising over two storeys, offering pleasant views of the outdoor space around. Up the stairs is a gallery with rooms for the various children's groups. A reading room, science room, music room and workshop are all accommodated on the upper

floor and oriented to the open, common areas. The play garden to the south of the building can be reached through a set of large, glazed doors.

The lobby and group rooms are all oriented to the South. The clear orientation of the open areas to the South and the use of skylights demonstrate how direct sunlight influences the ambiance of a room depending on the time of the year, day, and weather. The large outdoor area is designed in such a manner that it is perceived as a protective belt surrounding the building. A parapet walk surrounds the building leading downstairs into the garden. This path offers the children the opportunity to view the trees, meadows and hills from varying perspectives.

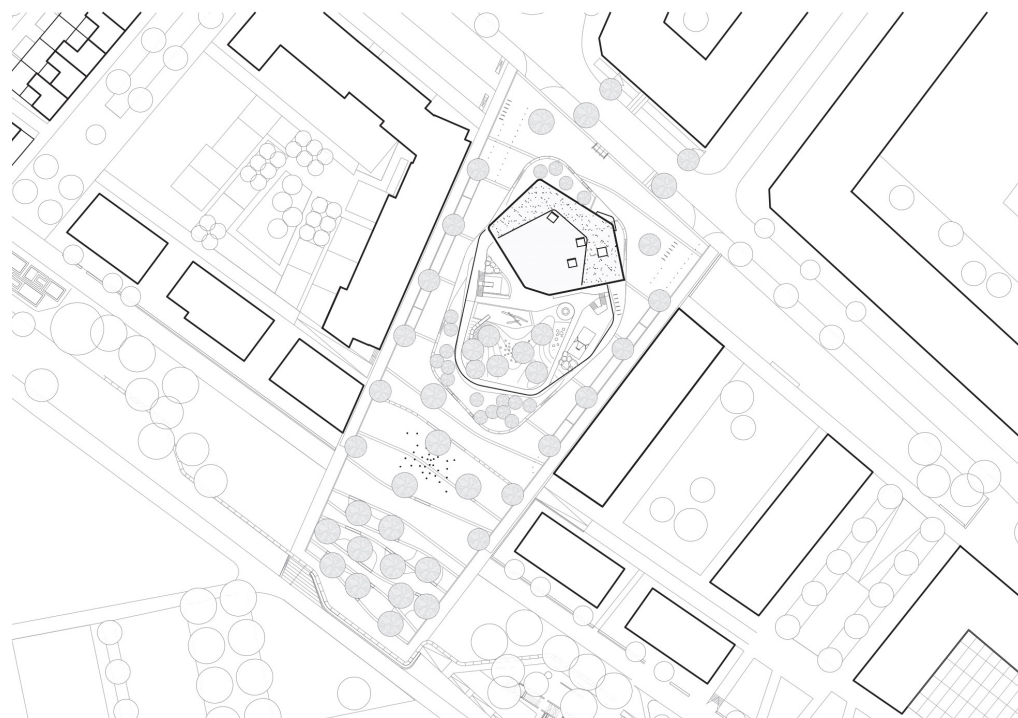

Site plan





Level 1

