



EXTENSION THERMAL SPA BAD AIBLING

BAD AIBLING, GERMANY, 2014-2015

Client

Stadtwerke Bad Aibling

Architect

Behnisch Architekten, München

Competition

2014, study

Completion

2014-2015

Gross

388 m² / 4,176 sq.ft.

Volume

1.228 m³ / 43,366 cu.ft.

Address

Lindenstraße 32

83043 Bad Aibling

Germany

The Thermal Spa Bad Aibling was built in the years 2005 to 2007 designed by Behnisch Architekten. From the beginning it proved to be very popular with visitors, so that the client expressed a wish for additional floorspace, in particular for more relaxation and resting areas. The two-storied extension building is a continuation of the design concept of the main thermal baths building and inserts itself into the existing built context. The large expanse of the glazed façade permits a maximum of incident sunlight. In terms of its construction method, it is similar to that of the existing façade. Wood, concrete and tiles in the interior pick up on the material theme of the earlier building and imbue the new addition with an atmosphere that is at the same time vibrant, bright and snug. The tiles that were used in the predecessor building are also used for the new resting areas in order to create a natural bridge between old and

new. This is the central hub and passageway from which visitors can access the existing indoor and outdoor sauna areas, which links the old and the new buildings. It also represents the gateway to the new resting zone which features a timber construction that swings outward to embrace the annex in the south. There are reclining beds here, but also further on, along the west- and south-facing facades. From the central entrance hall which stretches across two stories and is furnished with various seating possibilities, a wide, open staircase leads to the upper story that has been designed as part gallery, part large open space. Reclining benches and other seating furniture are used to define different zones. In the large, western part this area the furniture can be arranged in whatever way required, whereas in the eastern part there is a choice between a fixed or flexible arrangement.





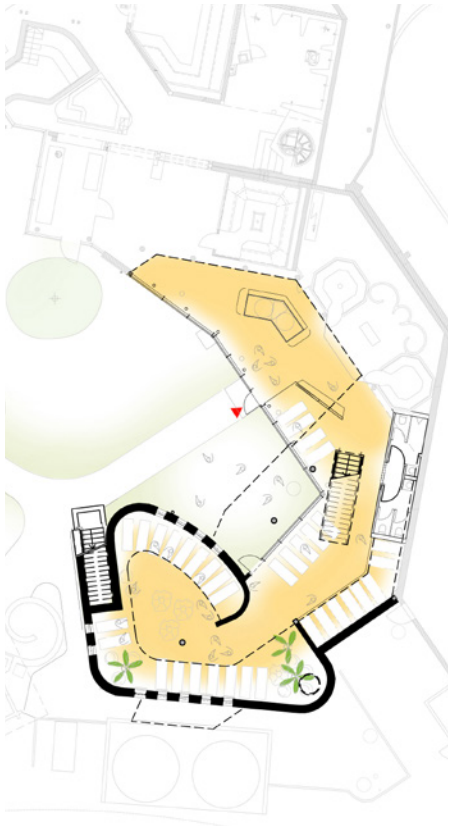

Level 1